

# Phase 1 Projects

## Phase 1 Projects

The Phase 1 Projects include all the areas in the TDOT Excess Land Transfer as well as the terminus to the James White Parkway. The Terminus and Baker Creek Preserve area include the majority of amenities and improvements and are connected by the park drive and multi-use greenway trails.

1. James White Parkway Terminus
2. Park Drive and Greenway
3. Tilson Connector and Play Forest
4. Baker Creek Preserve
5. Cottrell St.





## Gateway Park Circulation

The foundation of the new park is a well-connected and multi-modal circulation system, that seamlessly links all areas of the park for bikes, pedestrians and vehicles alike. Attention is paid not only to connections within the park, but also to how the circulation connects to the adjacent neighborhood streets.

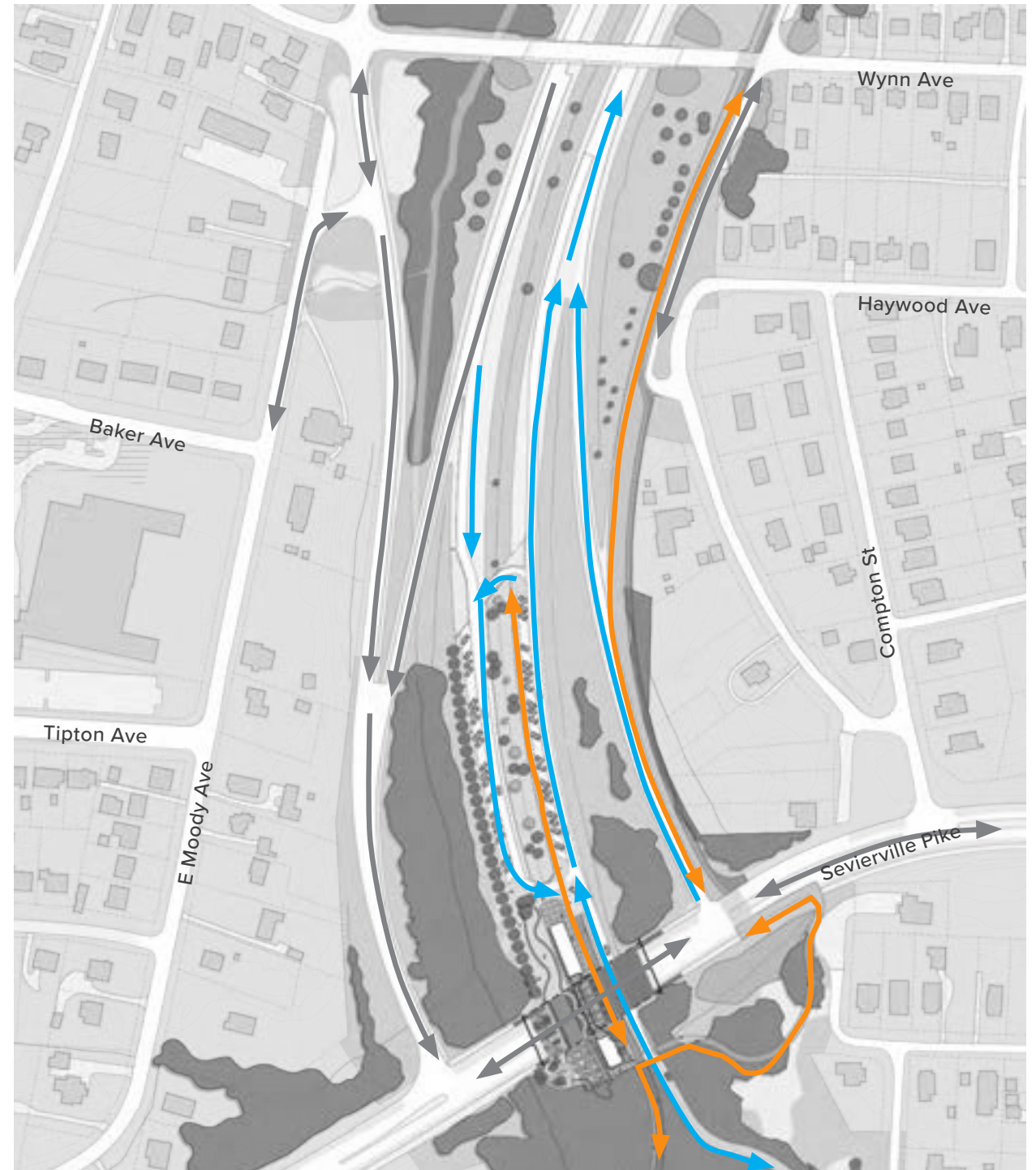
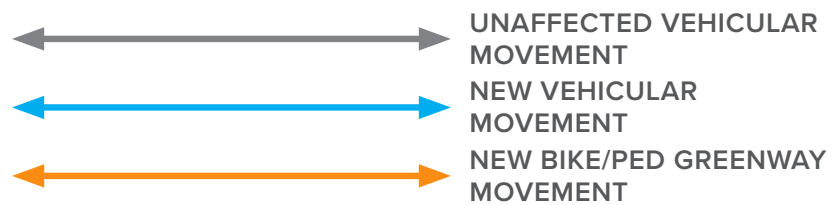



## Park Drive

A new park drive will connect the new parking at the James White Parkway Terminus to Tilson Street and the Baker Creek Preserve.

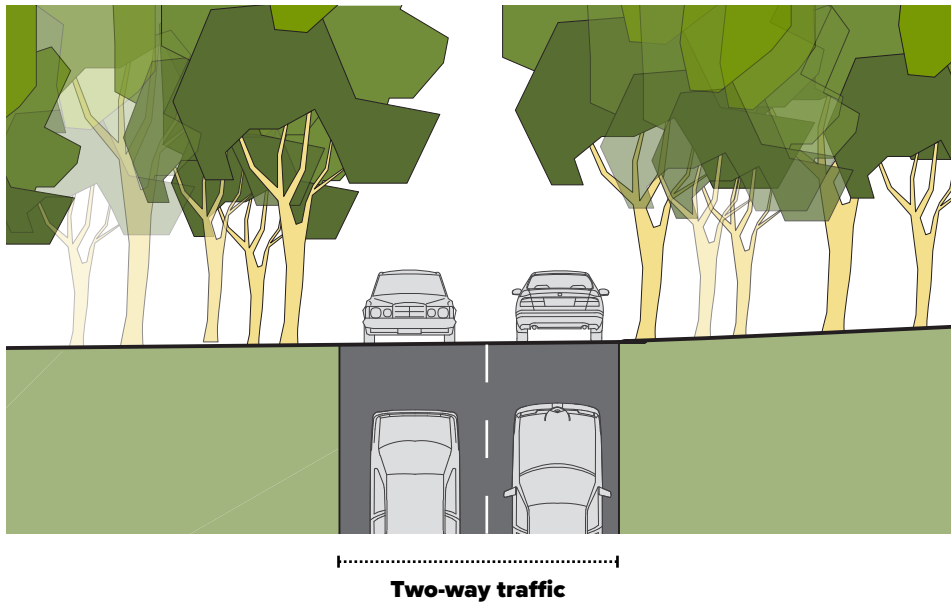

## Bike and Pedestrian Greenway

A new multi-use greenway and parallel compacted dirt trail will connect the parking and amenities at the James White Parkway Terminus to the Woodland, Play Forest, and Baker Creek Preserve areas.

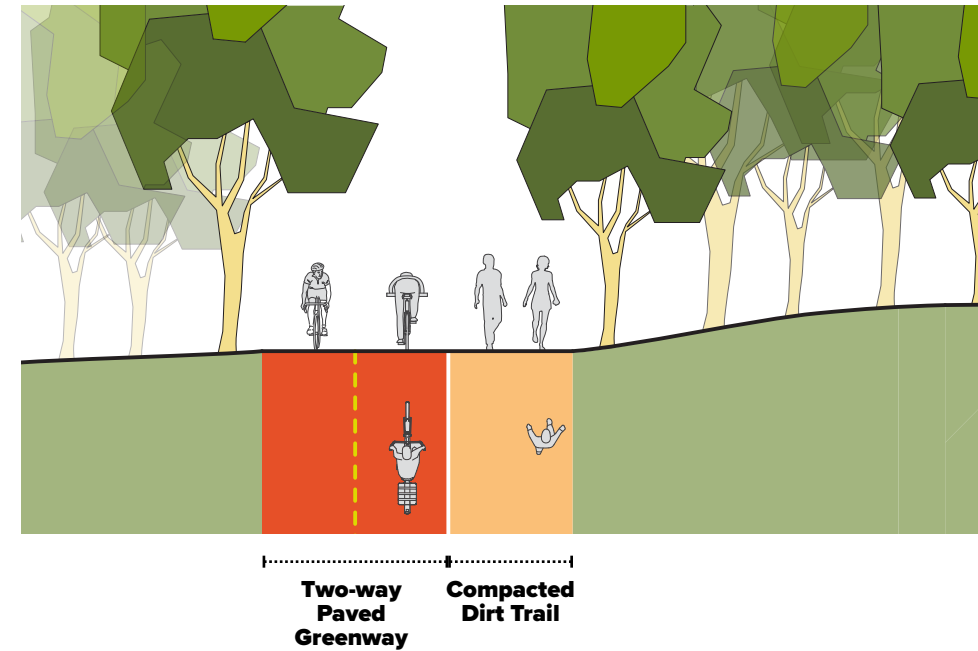

# Tilson Street

New angled parking will be added in small groups intermittently to the south side of Tilson Street, along with footpaths to connect the parking to the adjacent greenway.

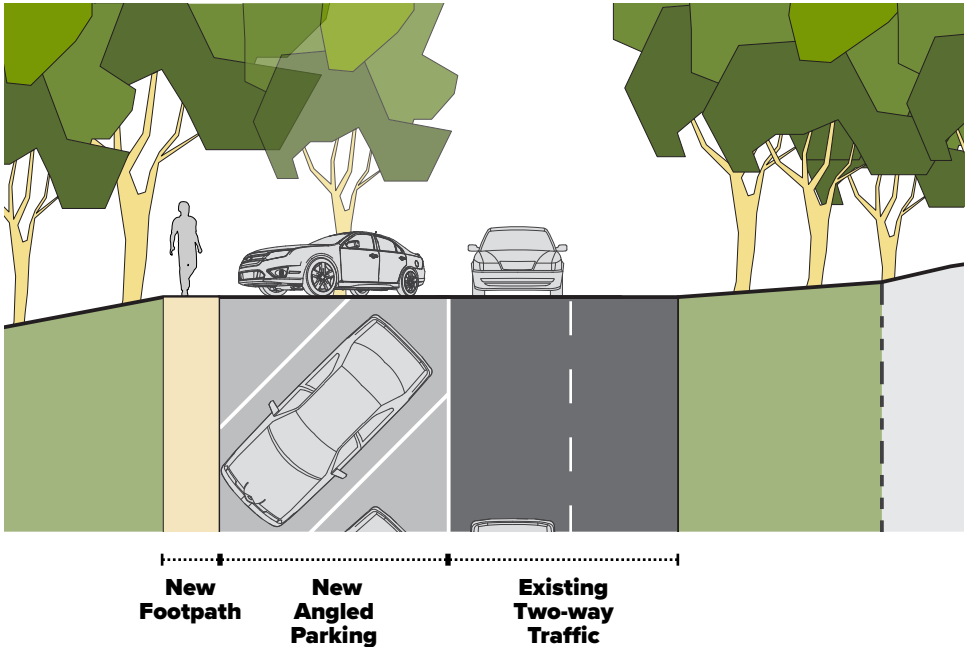

# Decatur Drive

Pedestrian and bike facilities will be added to Decatur Dr., between South Doyle Middle School parking lot and the park greenway, to allow for park goers to park at the middle school and safely access the park on bike or foot. This improvement also facilitates school and BMX park logistics, providing ease of access for school drop off and pickup and new BMX park improvements.

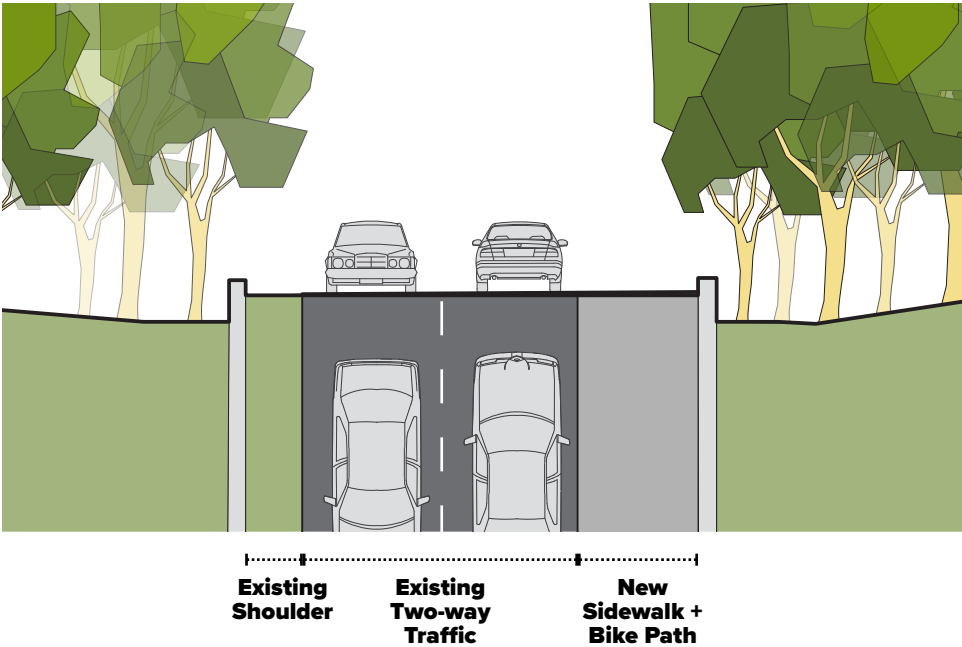

## James White Parkway Terminus

A highway dead end and underpass bridge, the James White Parkway Terminus is an incredibly unique place with charismatic features. The two worlds of the site - urban and wild - abut one another here to create a strong, distinctive threshold. The underpass frames views to the Parkway and Woods, further accentuating the differences north and south of the bridge. The design accentuates these differences and celebrates the Sevierville Pike bridge as a framing device and a place for play.

70

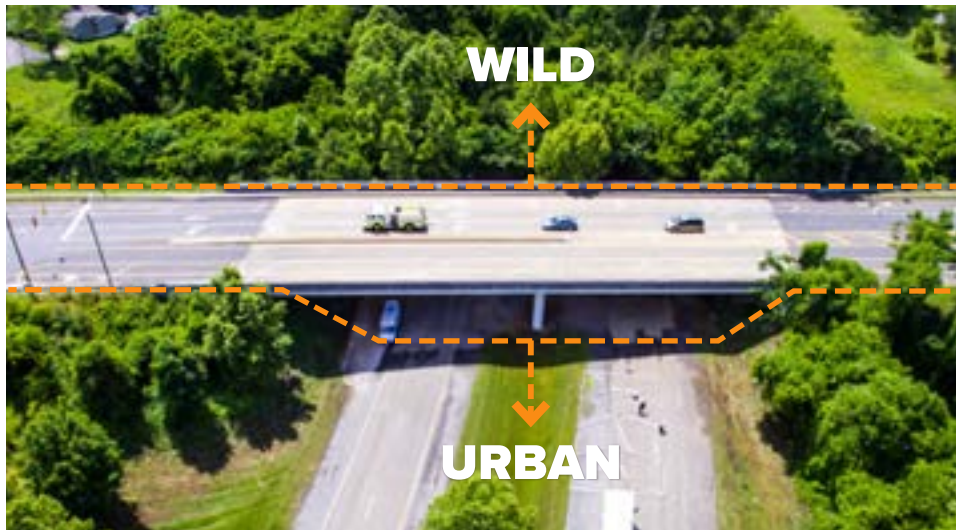





Proposed James White Parkway Terminus looking south

**Enhance the infrastructural character north of the Sevierville Pike bridge.**



**Enhance the natural character south of the Sevierville Pike bridge.**



**Maintain the existing abrupt transition from urban to wild.**

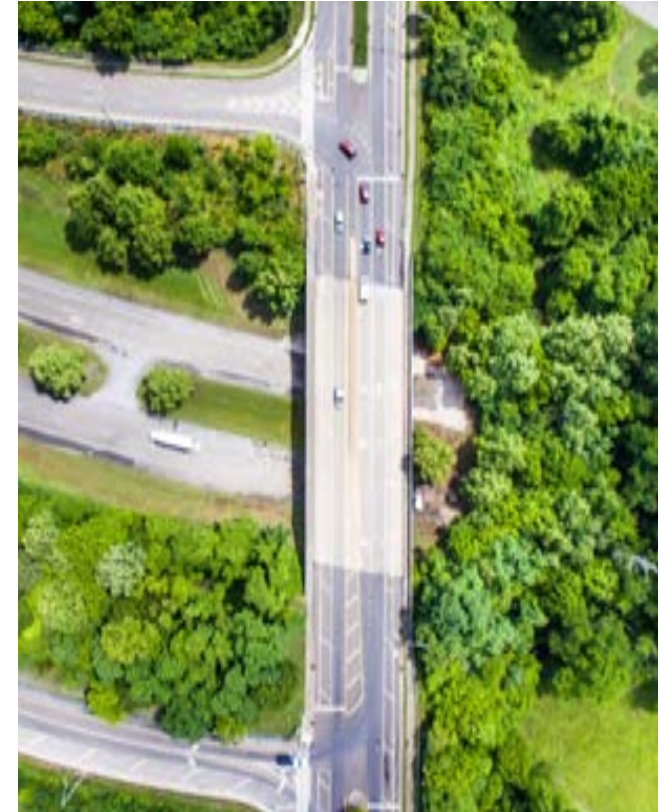

**Repurpose existing highway infrastructure.**



**Make the underpass a unique experience.**



**Create a destination for play + gathering.**



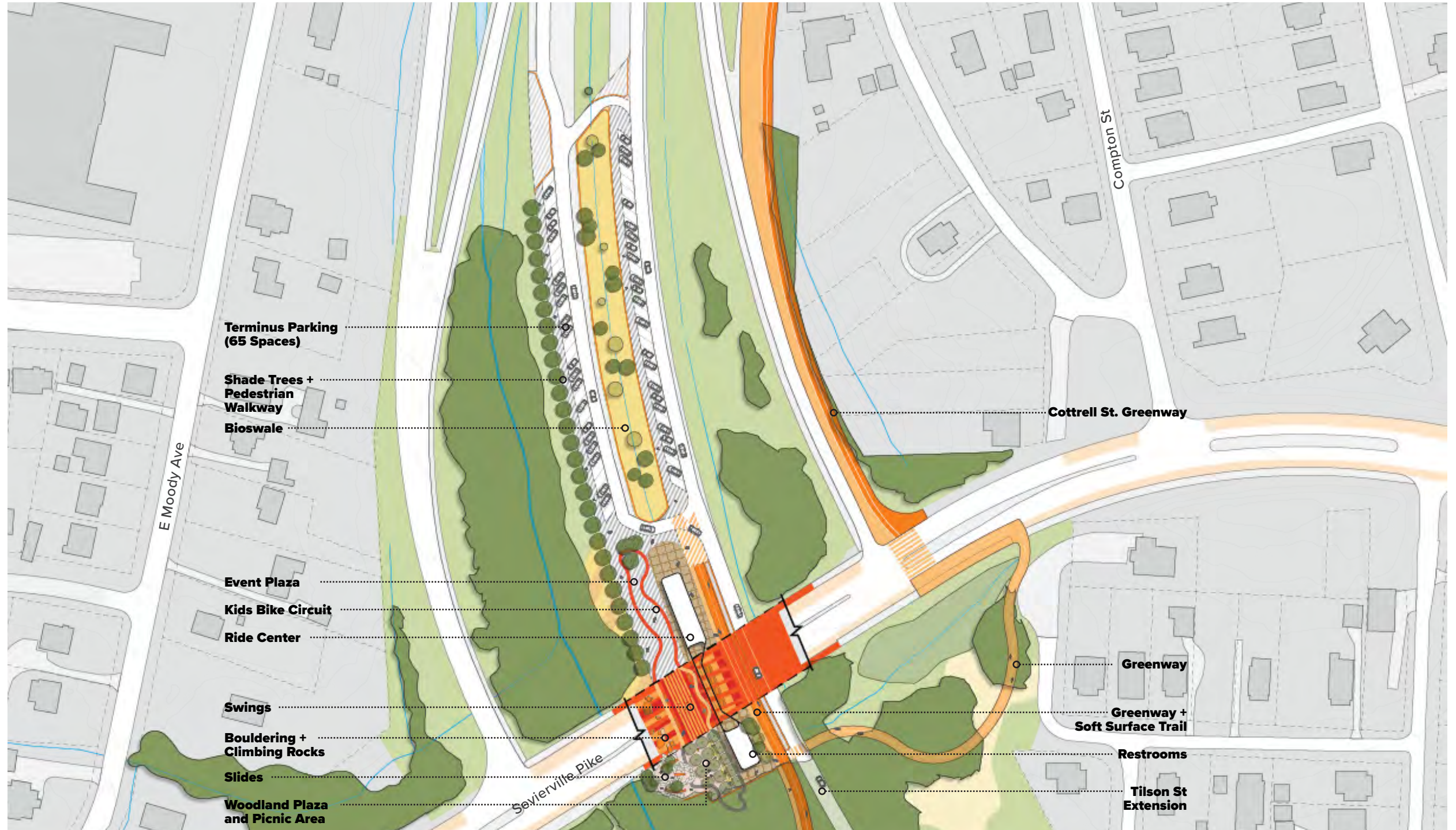

74



75

Event Plaza with Kids Bike Circuit and Pavilion.

## Terminus Play Features

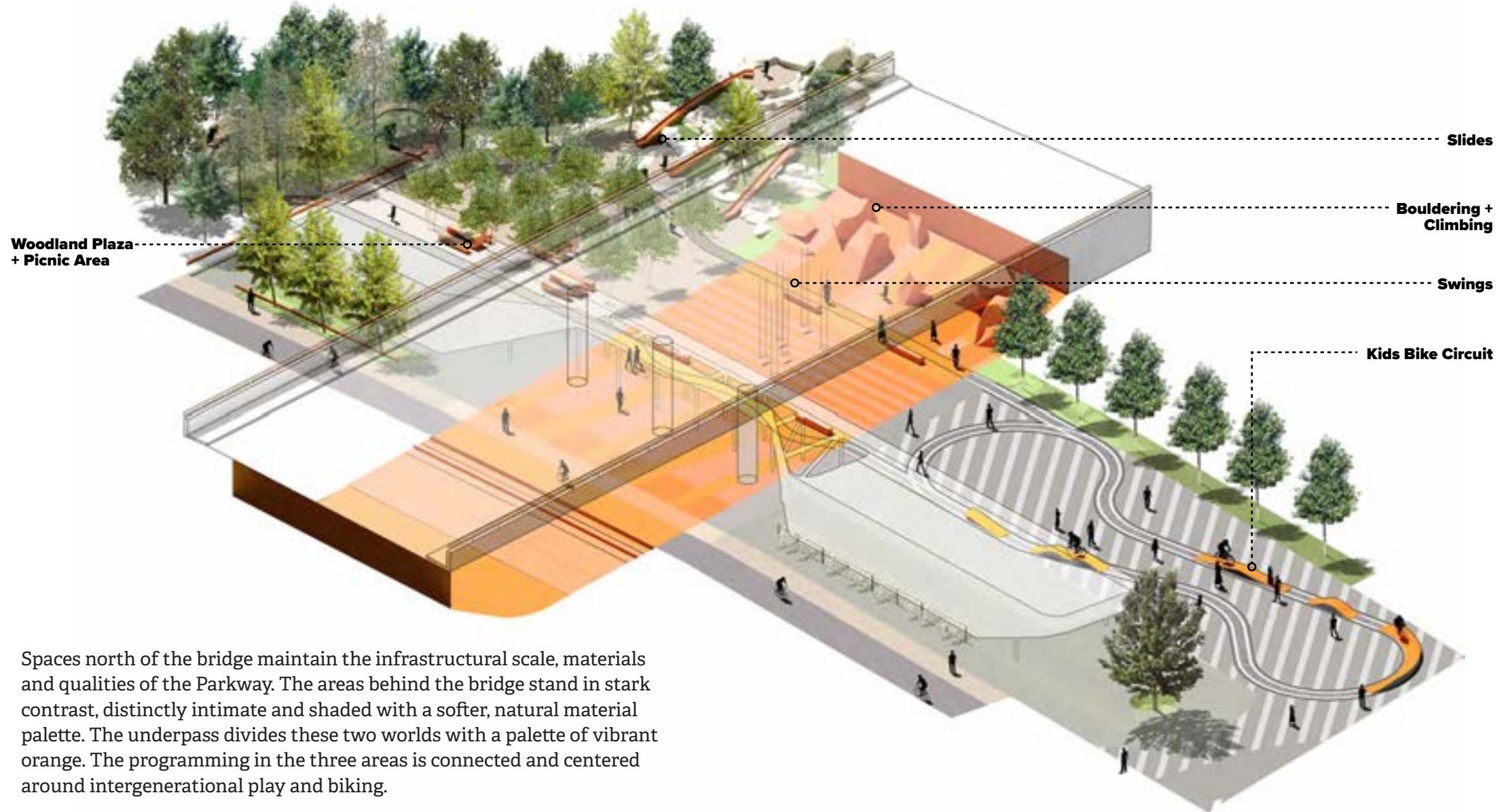

Spaces north of the bridge maintain the infrastructural scale, materials and qualities of the Parkway. The areas behind the bridge stand in stark contrast, distinctly intimate and shaded with a softer, natural material palette. The underpass divides these two worlds with a palette of vibrant orange. The programming in the three areas is connected and centered around intergenerational play and biking.

# Kids Bike Circuit

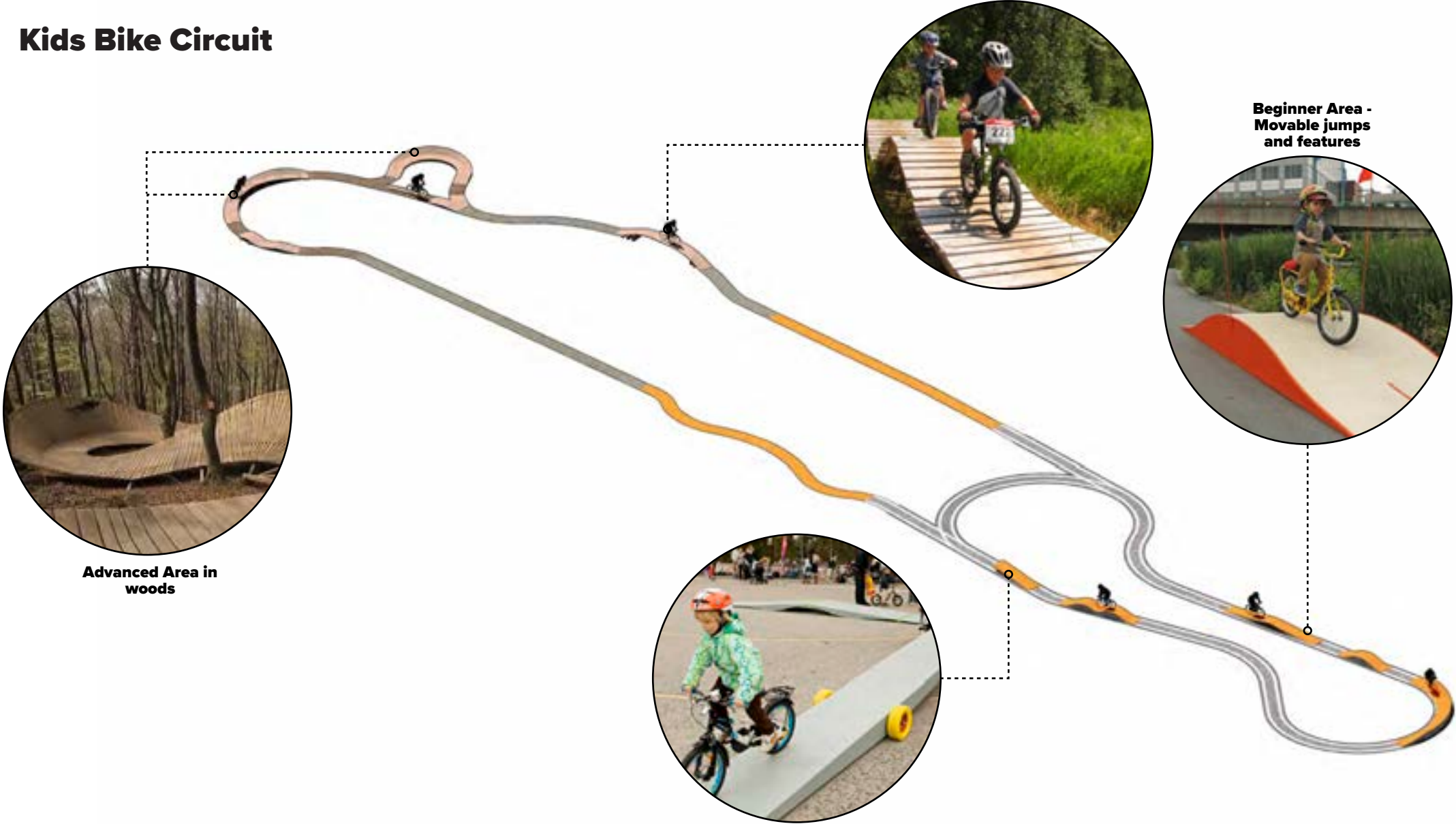

**Advanced Area in woods**



**Bridge**



**Beginner Area - Movable jumps and features**



**Beginner Area - Movable jumps and features**

## Bridge Underpass

The underpass is a playful and highly programmed space, taking advantage of the shade and shelter provided by the bridge. The pavilion structure separates the pedestrian and play spaces from the greenway and park drive.



**Existing Site Conditions**



**Surface Materials: Epoxy-coated Asphalt, Rubber Safety Surface, Synthetic Track Surface, Paint**





## Woodland Plaza

Occupying the clearing that currently exists behind the underpass, the woodland plaza is a soft, shaded gathering space planted with multi-stem trees and furnished with picnic tables. Slides and rocks are built into the existing embankment hill and frame the west edge of the space.

80



**Existing Site Conditions**



**Big Slides, Governor's Island; Picnic Grove, Duisburg-Nord**



## Tilson Connector and Greenway

Improvements in this area are limited to circulation and parking. The minimal footprint is meant to preserve as much of the existing woodland and meadow landscape as possible.

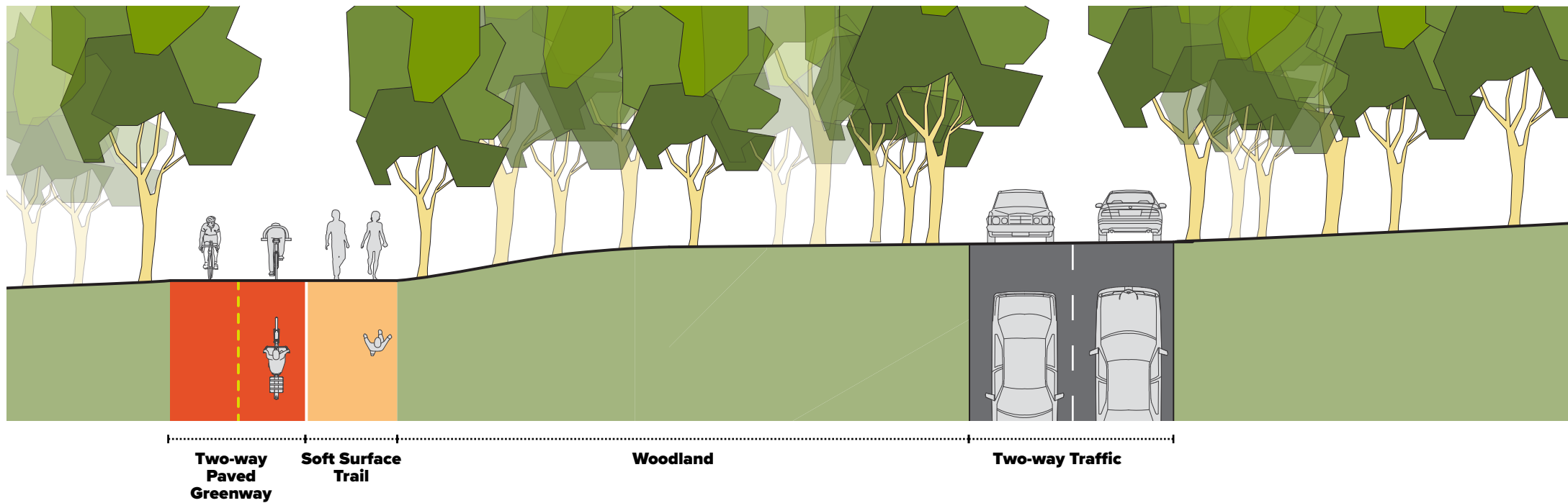



## Tilson Street and Play Forest

Work in this area is limited, like the Tilson Connector segment. Angled parking is added to Tilson Street and the greenway and multi-use trails extend to connect across Taylor Rd to the Baker Creek Preserve. Footpaths connect Tilson Street to the greenway. The greenway is intended to move past the Play Forest (without disturbing these areas) and require minimal grading.

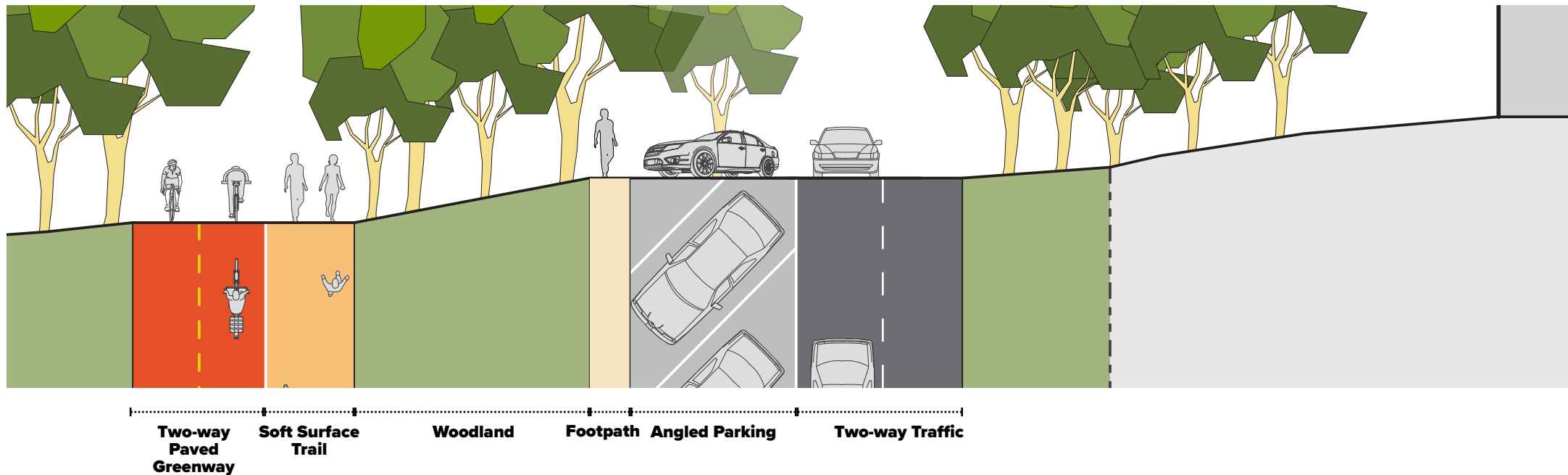



- Greenway + Soft Surface Trail**
- Angled Parking**
- Footpath**
- Play Forest**

## Baker Creek Preserve

Improvements at the Baker Creek Preserve Trailhead create a more open and public entrance to the site's famous mountain biking trails with a large sloped lawn, soft plaza gathering space, picnic pavilion, and parking. The design incorporates the Kids Mini Pump Track and re-locates and enhances the Adventure Play Area along the north edge of the lawn. The greenway winds through the site and ends at the trailhead, completing the connection from the Terminus.

86



**Existing Conditions**



**Existing Adventure Play Area and Kids Mini Pump Track**





**Enhance + organize existing site uses.**



**Enhance the existing natural character and preserve existing trees + woodlands.**



**Create an appropriate entry space to the world-class bike trails at Baker Creek Preserve.**



**Provide formal parking opportunities at Baker Creek Preserve.**



**Create space for events and gathering.**



**Provide accessible paths + loops for all ages, mobility + skill levels.**





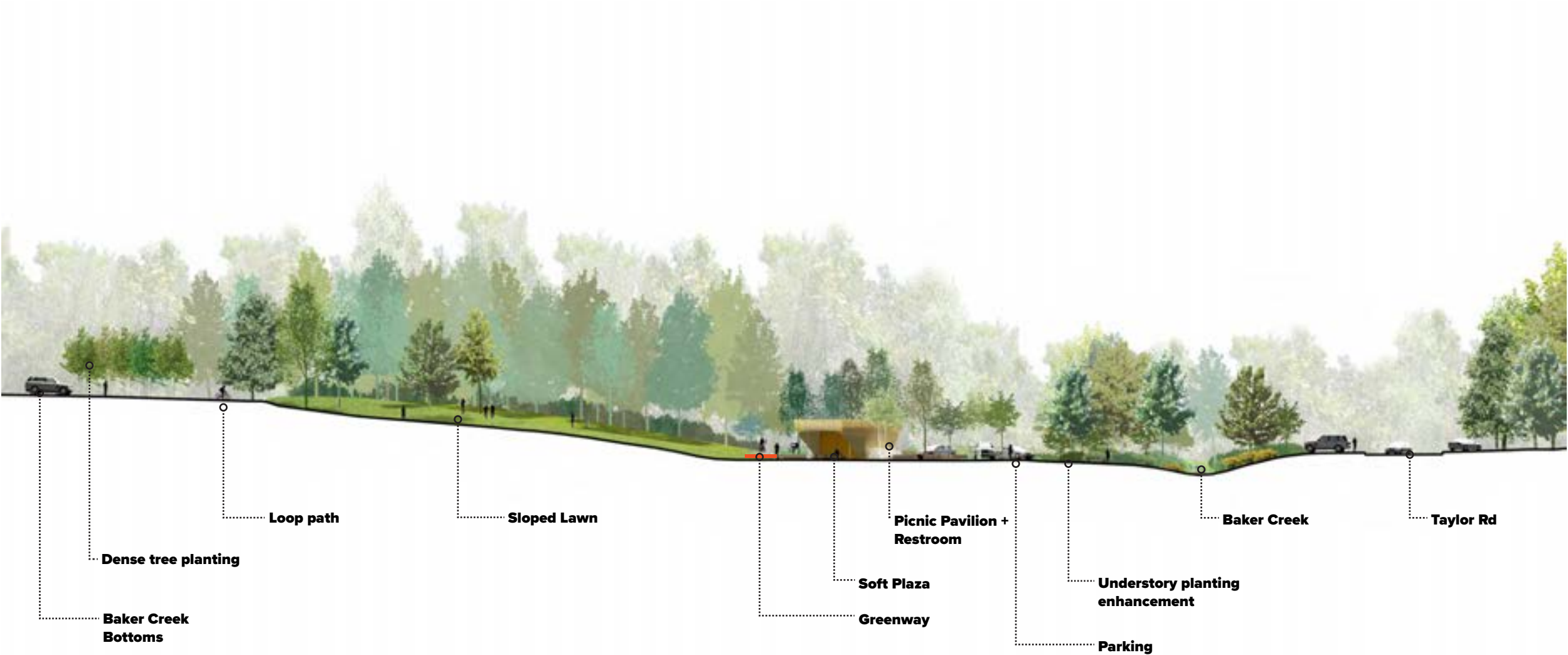



Sloped Lawn viewed from Baker Creek Bottoms Entrance



Northern greenway access to Soft Plaza and Pavilion.

## Soft Plaza, Kids Mini Pump Track



**Kids Mini Pump Track; Soft Plaza**

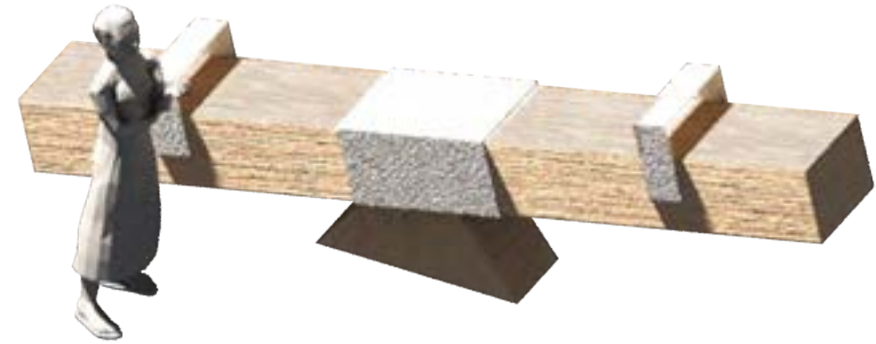

**Timber See-saw**

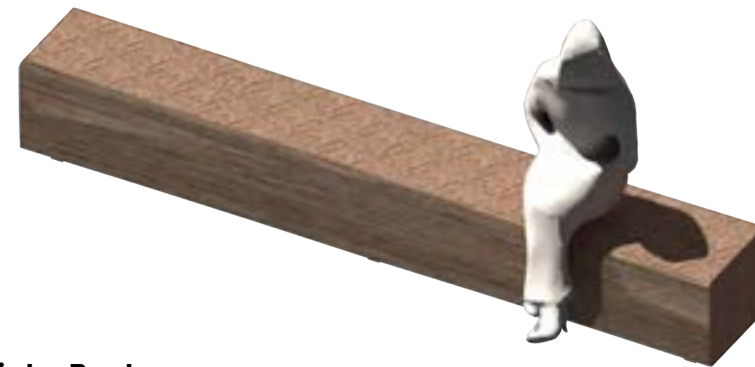

**Timber Bench**





Northern greenway access to Soft Plaza and Pavilion.

## Phase 1 Building Programming

Phase 1 projects at the terminus and Baker Creek Preserve include building program at each location which supports active landscape program at each location.

### The Terminus

At The Terminus this programming consists of a ride center which includes wayfinding and orientation components along with bicycle and support functions. The ride center also doubles as a covered support space for events within The Terminus. A comfort station is also proposed along with a covered space supporting the woodland plaza and playground.

### Baker Creek Preserve

Baker Creek Preserve programming includes a picnic and shade pavilion located adjacent to the existing pump track. Wayfinding and orientation elements are also proposed along with some bicycle support functions. This pavilion also includes a comfort station providing support for the plaza space, open lawn, and play areas.





BAKER CREEK PRESERVE PAVILION

## Ride Center

The Ride Center is envisioned as a central hub for bicycle activities within the Urban Wilderness. The Ride Center will support multi-modal transit including a public transportation hub. The Ride Center will include facilities for bicycle storage and repair as well as wayfinding and orientation elements associated with the trail system.



Bikestation - Sudio FV



Radhaus - Osterwold + Schmidt



Glentress Park Visitor Center, Scotland - Gaia Group



Traffic House, Copenhagen - MLRP



Wyde Mountain Bike Trail, Sydney - Group GSA

## Picnic and Shade Pavilion

The picnic and shade pavilion is envisioned as an open air structure providing shade and shelter adjacent to planned landscape program activities at Baker Creek Preserve. The pavilion will also provide facilities for bicycle storage as well as wayfinding and orientation elements.



Naples Botanical Garden Visitor Center - Lake Flato



Lizard Log Parklands, Sydney - Chrofi



Wantou & Vanke Paradise Art Wonderland - ASPECT Studios



Ballast Point Park, NSW - Chrofi



Sharon Fieldhouse, Virginia - Design/buildLAB

## Comfort Station

Comfort stations are planned at The Terminus and Baker Creek Preserve. Built of durable materials, the comfort stations are envisioned as independent infrastructure elements within the open-air pavilions. Non-gendered restrooms and changing facilities are planned along with a water station and outdoor showers.



Riverview Park, Louisville - Deleon Primmer Architecture Workshop



Lizard Log Parklands, Sydney - Chrofi



Parramatta Park, NSW - Chrofi





Cook Park, NSW - Fox Johnston



Lady Bird Lake Trail Restroom, Austin - Miro Rivera



Toilet Pavilion, Sydney Park - JMD Design

## Wayfinding and Orientation

At both The Terminus and Baker Creek Preserve there is an opportunity for wayfinding and orientation components to be integrated within the building structures. In this way it is envisioned that the building elements can be individually coded to their unique locations within the larger Urban Wilderness context. This will allow for an intuitive solution to a system-wide wayfinding plan.

104



The Goods Line, Sydney - ASPECT Studios



QV Melbourne Carpark, Melbourne - Latitude Group



Pottery Road, Toronto - PLANT Architect



PARK[E]ING, Venice - Stradivarie Associated Architects



Amager Strandpark, Copenhagen - HOGK

# Terminus Pavilion

## Building Program (4,400 SF):

### 01 Ride Center

- Bike concierge/learning center
- Bike share station
- Bike service station (repair + wash)
- Bike storage
- Events pavilion/meeting space
- Picnic Tables
- Trash + Recycling

### 02 Comfort Station

- Bathrooms (Heated)
  - 4 lockable non-gender
- Janitor Closet (Heated)
  - Mop sink
  - Storage area & plumbing access
- Water station
  - Bottle filling + fountain
  - Outdoor shower
- Picnic Tables
- Trash + Recycling

### 03 Orientation and Wayfinding

- Urban Wilderness Gateway Park Branding
- Trail map + information kiosk
- Transit Stop

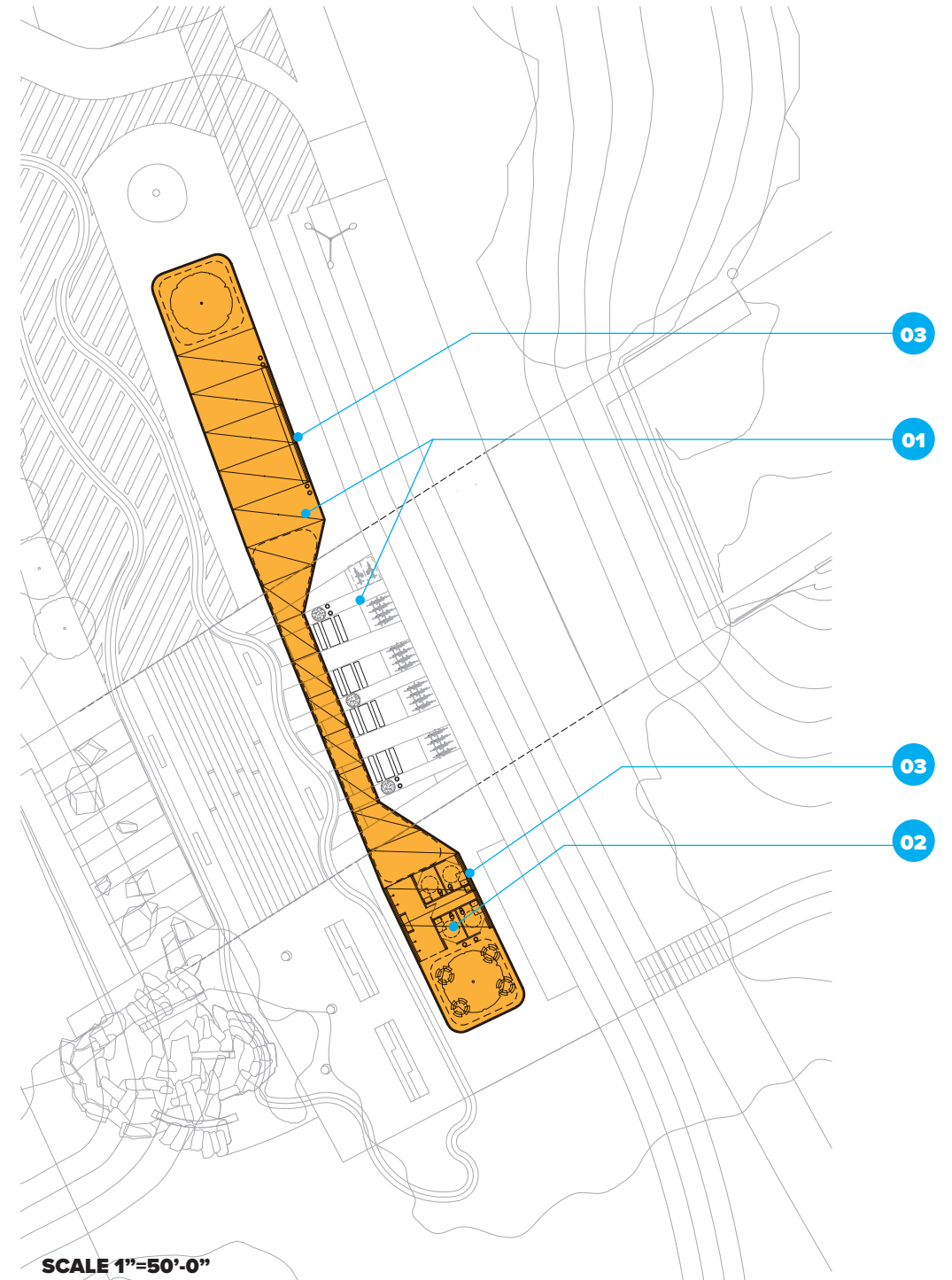

SCALE 1"=50'-0"

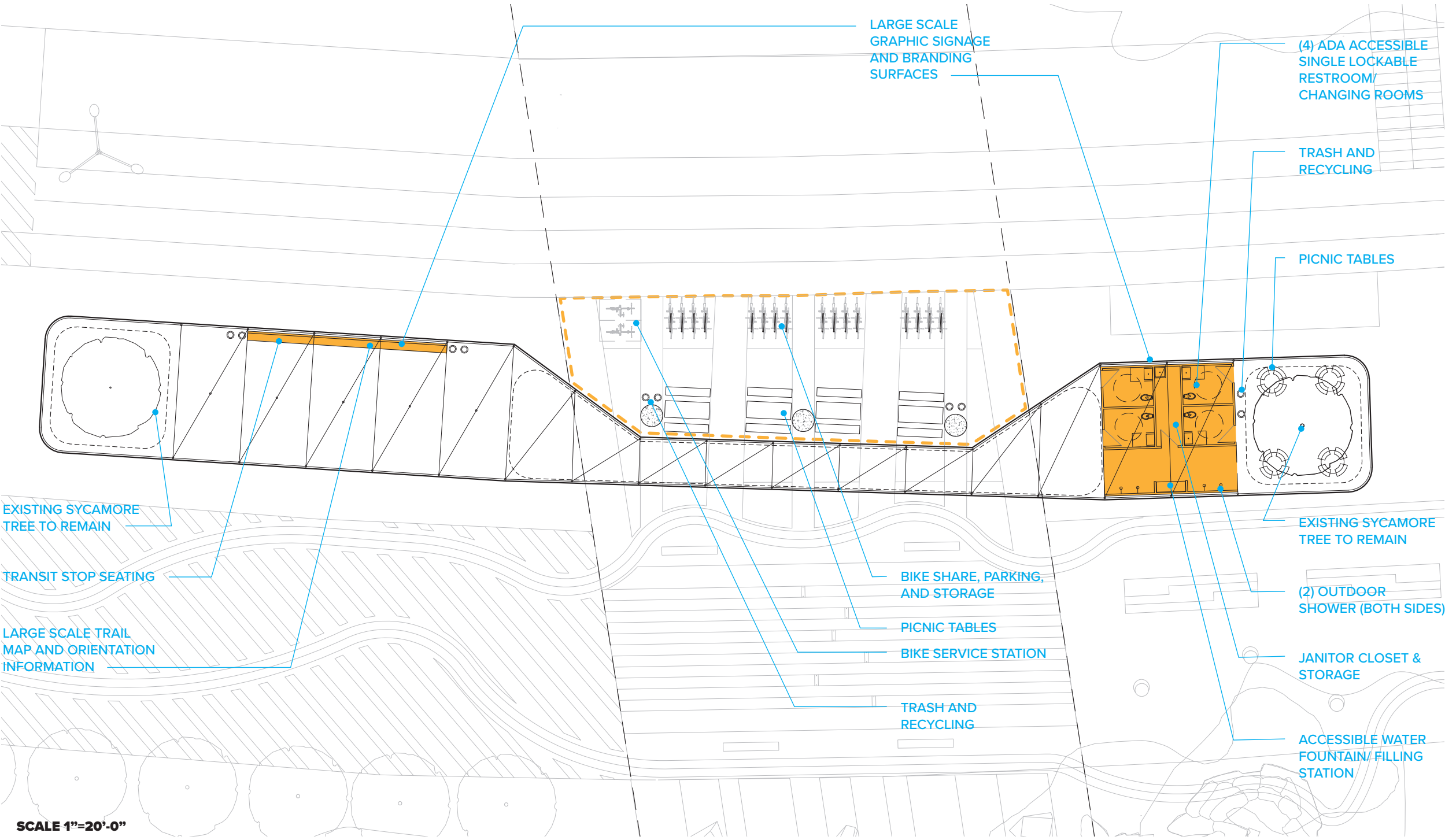

LARGE SCALE GRAPHIC SIGNAGE AND BRANDING SURFACES

(4) ADA ACCESSIBLE SINGLE LOCKABLE RESTROOM/ CHANGING ROOMS

TRASH AND RECYCLING

PICNIC TABLES

EXISTING SYCAMORE TREE TO REMAIN

TRANSIT STOP SEATING

LARGE SCALE TRAIL MAP AND ORIENTATION INFORMATION

BIKE SHARE, PARKING, AND STORAGE

PICNIC TABLES

BIKE SERVICE STATION

TRASH AND RECYCLING

EXISTING SYCAMORE TREE TO REMAIN

(2) OUTDOOR SHOWER (BOTH SIDES)

JANITOR CLOSET & STORAGE

ACCESSIBLE WATER FOUNTAIN/ FILLING STATION

SCALE 1"=20'-0"

## Terminus Pavilion Materials and Massing

The Terminus Pavilion is based on a 12' structural module which is adapted to fit the specific physical characteristics of the individual sites.

### Structure

A steel tube structural system is proposed as the primary frame for the buildings with a light weight steel substructure providing support for a skin system which provides shade and shelter while also defining space within the otherwise open pavilions.

### Skin

Skin options considered include perforated metal, structural bar grating, and an applied fin system. The skin will be durable with materials either being raw and durable, or powder coated for longevity.



Perforated Raw Sheet Steel



Perforated Painted Sheet Steel

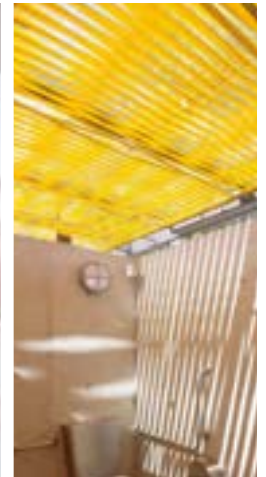

Woven Painted Steel



Painted Steel fins

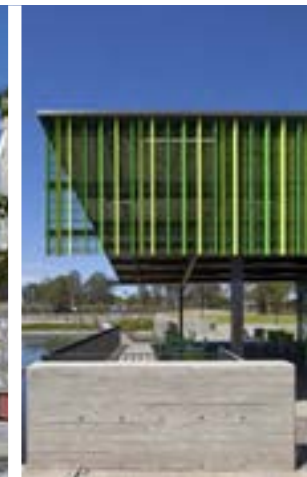

Painted Steel channel



Raw Steel Bar Grating

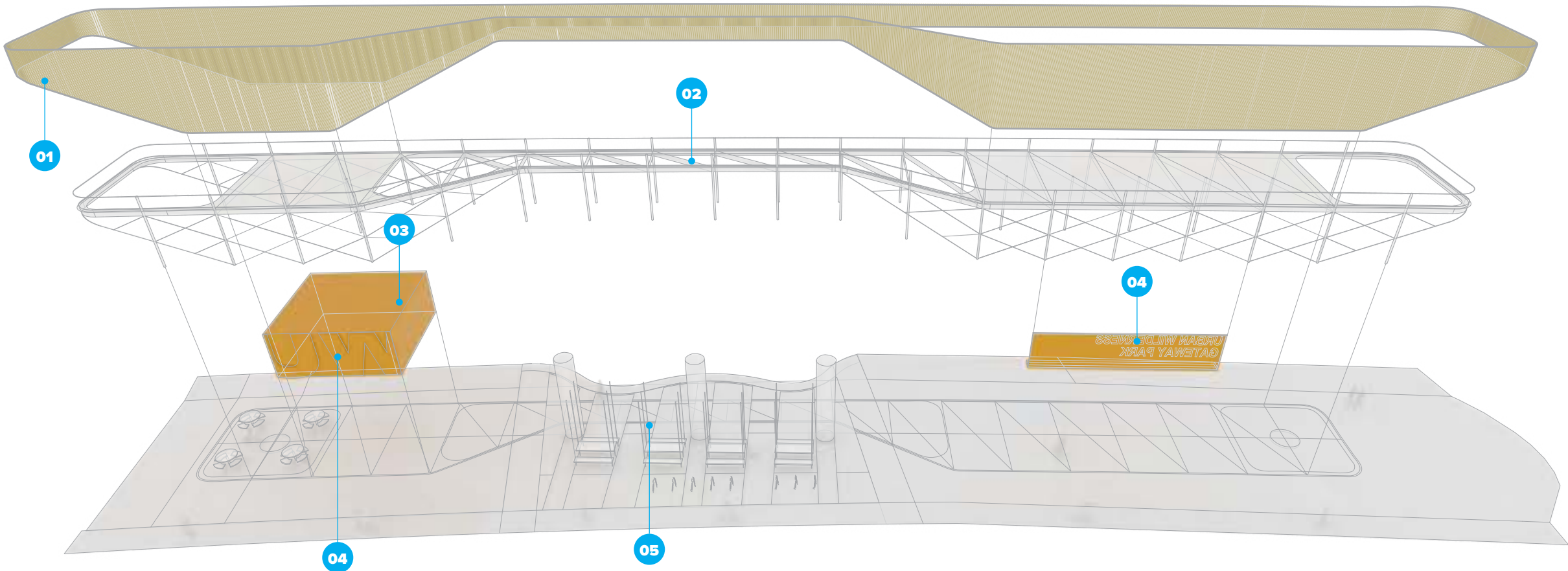

**01 Building Skin**  
A lightweight translucent or perforated system defines space and diffuses natural light while opening up to landscape program.

**02 Building Structure**  
Steel columns and beams are the primary structural system with a lattice steel substructure providing support for the building skin

**03 Building Program**  
Independent solid elements with integrated infrastructure support adjacent park activities

**04 Branding and Wayfinding**  
Branding and wayfinding unique to each Urban Wilderness location is integrated into building program elements

**05 Plaza Surface**  
Landscape program at the terminus extends through the open areas of the Gateway Pavilion

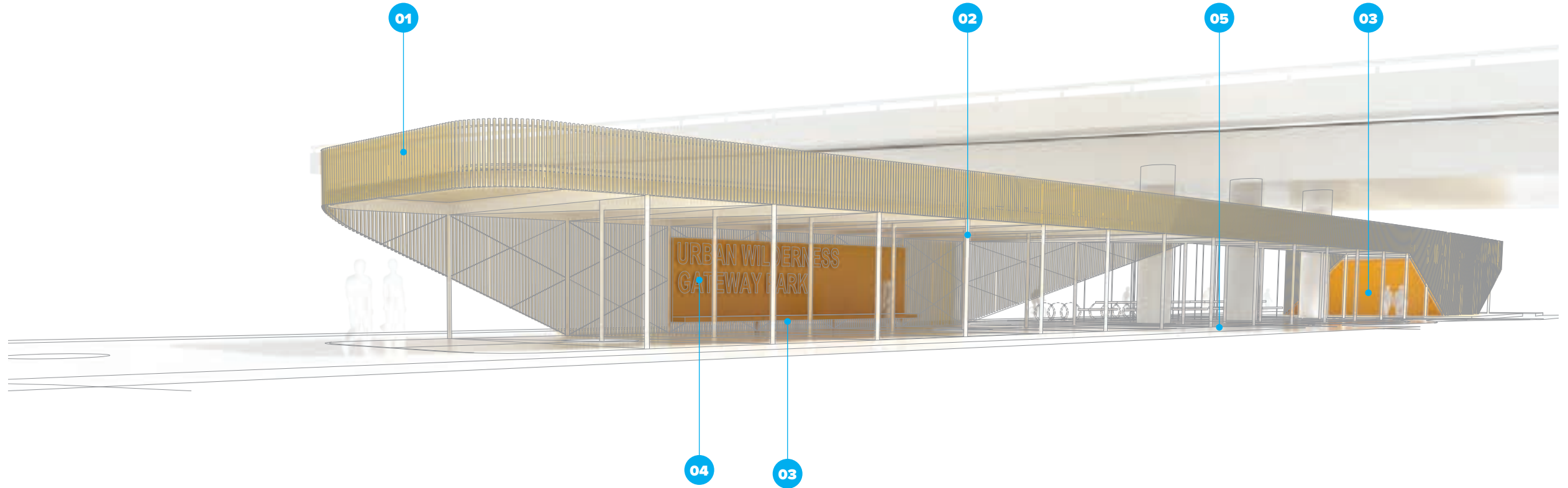



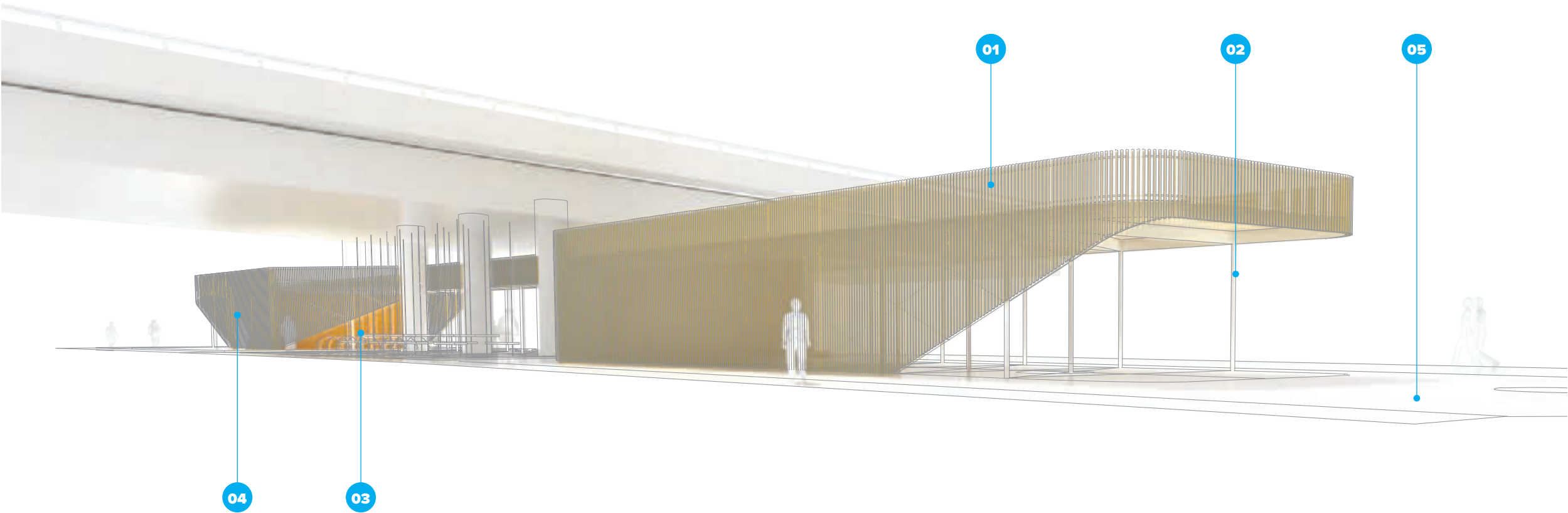

**01 Building Skin**  
 A lightweight translucent or perforated system defines space and diffuses natural light while opening up to landscape program.

**02 Building Structure**  
 Steel columns and beams are the primarily structural system with a lattice steel substructure providing support for the building skin

**03 Building Program**  
 Independent solid elements with integrated infrastructure support adjacent park activities

**04 Branding and Wayfinding**  
 Branding and wayfinding unique to each Urban Wilderness location is integrated into building program elements

**05 Plaza Surface**  
 Landscape program at the terminus extends through the open areas of the Gateway Pavilion

## Baker Creek Preserve Pavilion

### BUILDING PROGRAM (2,200 SF):

- 01 Picnic and Shade Pavilion**
  - Picnic pavilion/meeting space
  - Covered Seating Area
  - Bike service station (repair + air only)
  - Trash + Recycling
  
- 02 Comfort Station**
  - Bathrooms (Heated)
    - 2 lockable non-gender
  - Janitor Closet (Heated)
    - Mop sink
  - Water station
    - Bottle filling + fountain
    - Outdoor shower
  - Trash + Recycling
  
- 03 Orientation and Wayfinding**
  - Urban Wilderness Gateway Park Branding
  - Trail map + information kiosk



SCALE 1"=50'-0"

(2) ADA ACCESSIBLE SINGLE LOCKABLE RESTROOM/ CHANGING ROOMS

(2) OUTDOOR SHOWERS (BOTH SIDES)

ACCESSIBLE WATER FOUNTAIN/ FILLING STATION

JANITOR CLOSET & STORAGE

TRASH AND RECYCLING

COVERED SEATING AREA

(2) BIKE REPAIR & AIR STATIONS

TRAIL MAP | INFORMATION KIOSK

PICNIC TABLES

OPEN LAWN

EXISTING PUMP TRACK TO REMAIN

SCALE 1"=20'-0"

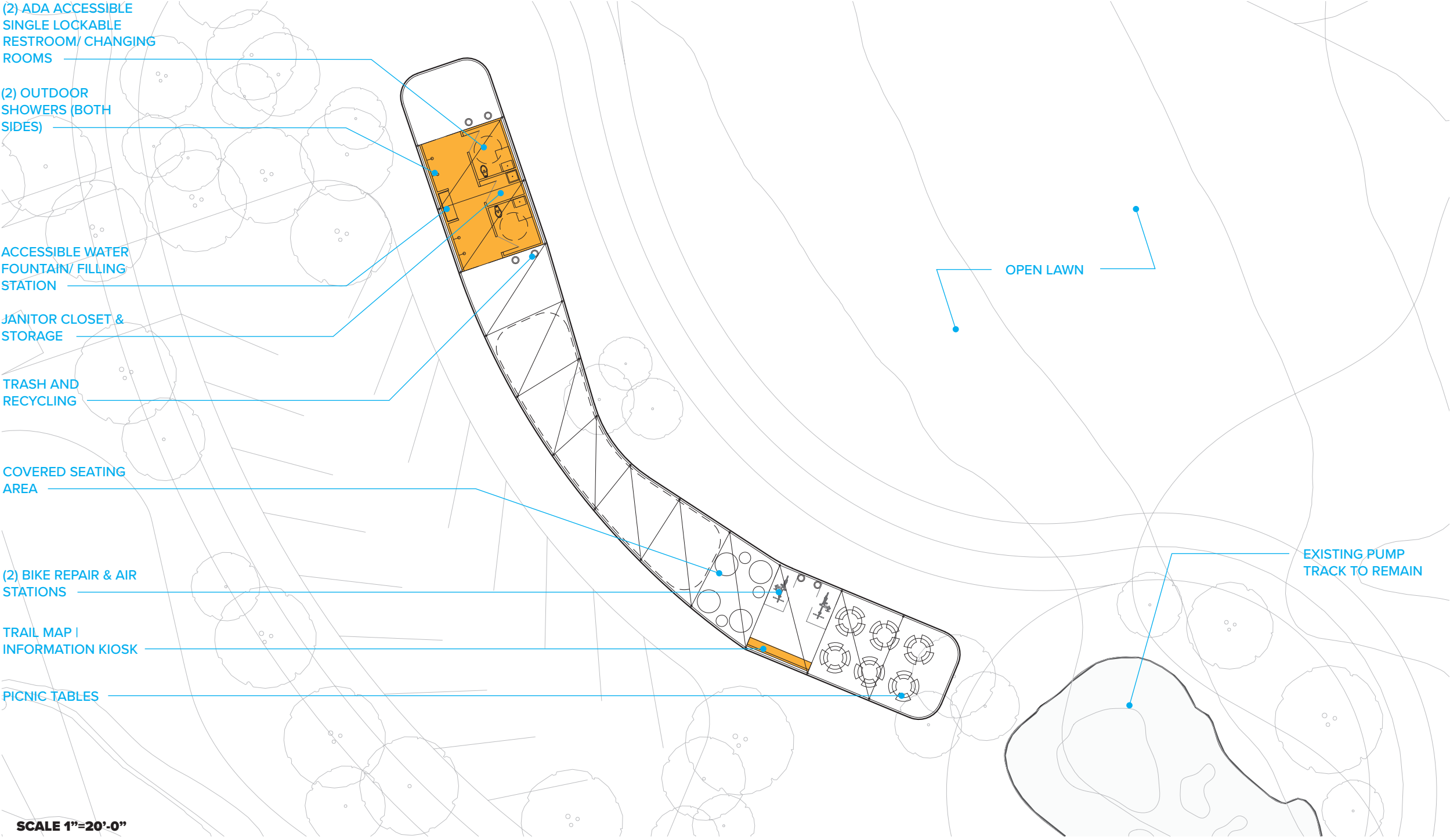

## Baker Creek Preserve Pavilion Materials

The Baker Creek Preserve pavilion is based on a 12' structural module which is adapted to fit the specific physical characteristics of the individual sites.

### Structure

A steel tube structural system is proposed as the primary frame for the buildings with a light weight steel substructure providing support for a skin system which provides shade and shelter while also defining space within the otherwise open pavilions.

### Skin

Skin options considered include perforated metal, structural bar grating, and an applied fin system. The skin will be durable with materials either being raw and durable or powder coated for longevity.



**Perforated Raw Sheet Steel**



**Perforated Painted Sheet Steel**

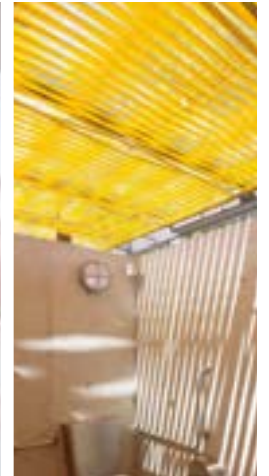

**Woven Painted Steel**



**Painted Steel fins**

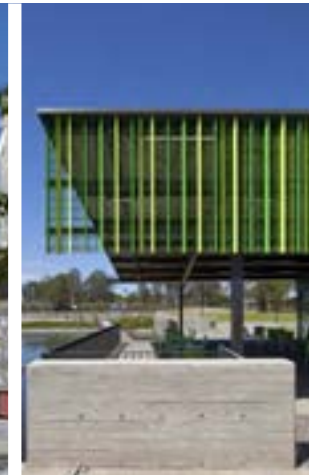

**Painted Steel channel**



**Raw Steel Bar Grating**

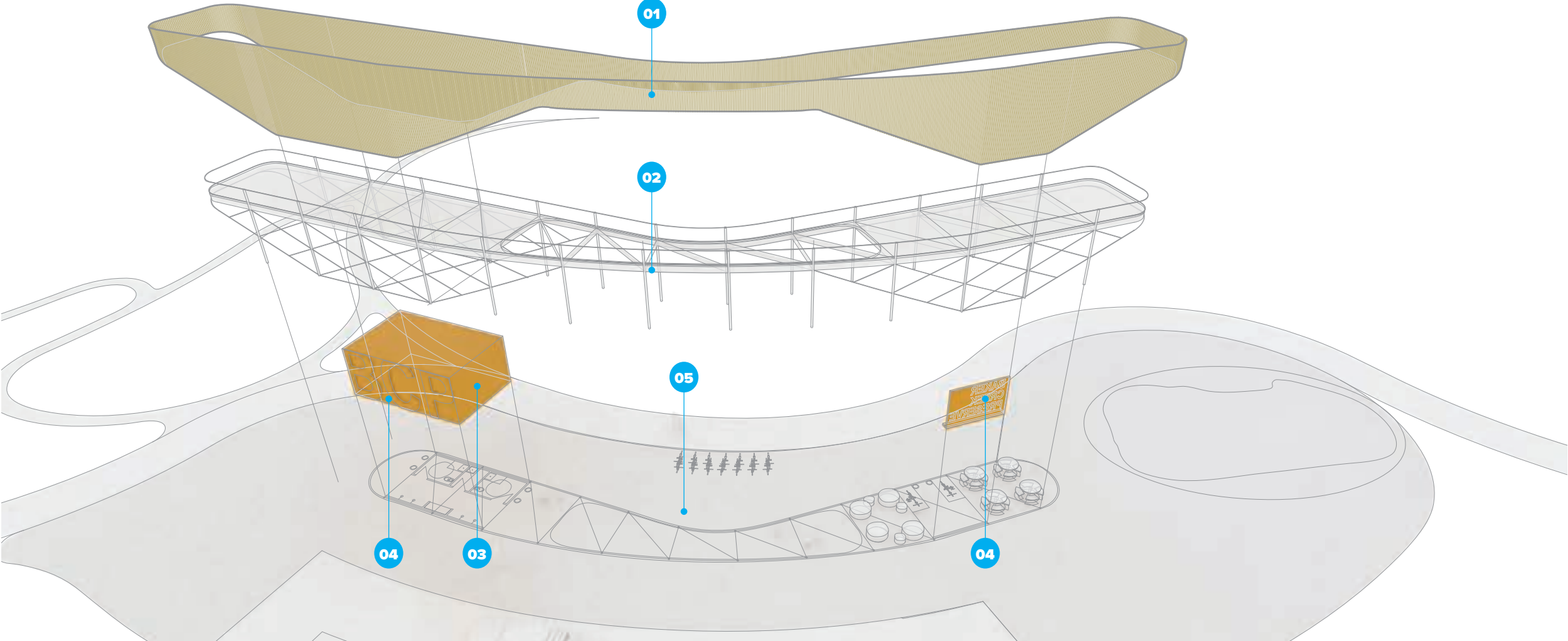

**01 Building Skin**  
 A lightweight translucent or perforated system defines space and diffuses natural light while opening up to landscape program.

**02 Building Structure**  
 Steel columns and beams are the primary structural system with a lattice steel substructure providing support for the building skin

**03 Building Program**  
 Independent solid elements with integrated infrastructure support adjacent park activities

**04 Branding and Wayfinding**  
 Branding and wayfinding unique to each Urban Wilderness location is integrated into building program elements

**05 Plaza Surface**  
 Landscape program at the terminus extends through the open areas of the Gateway Pavilion

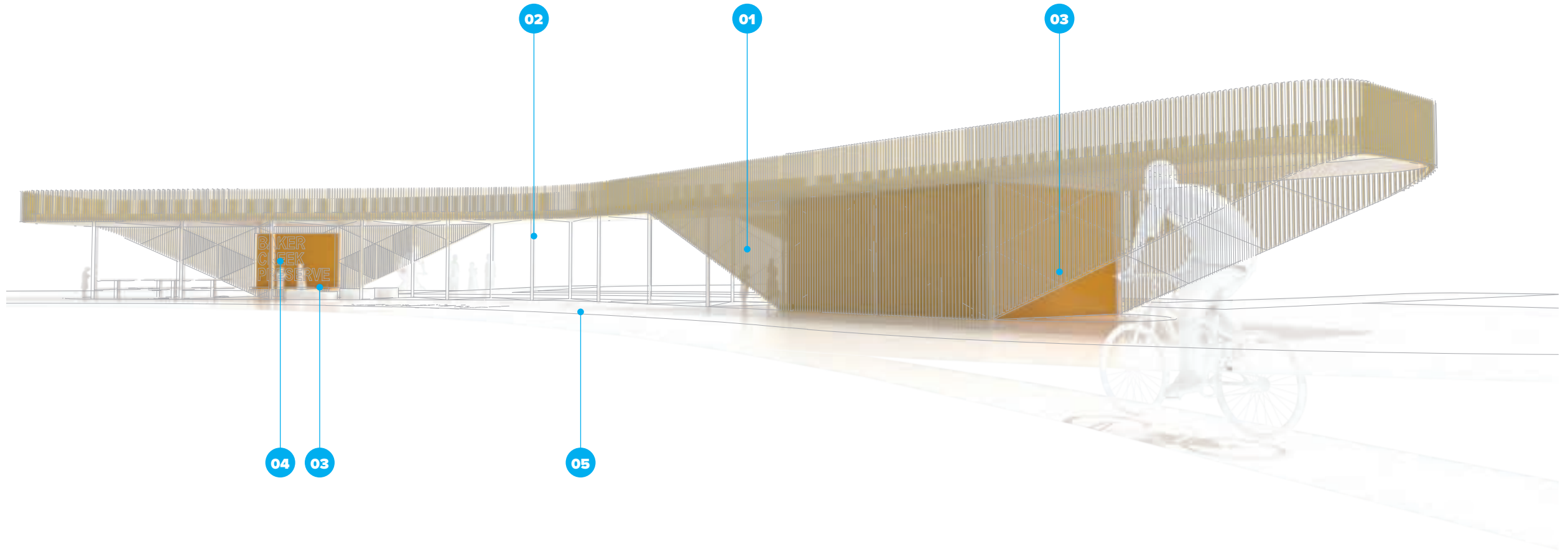

116

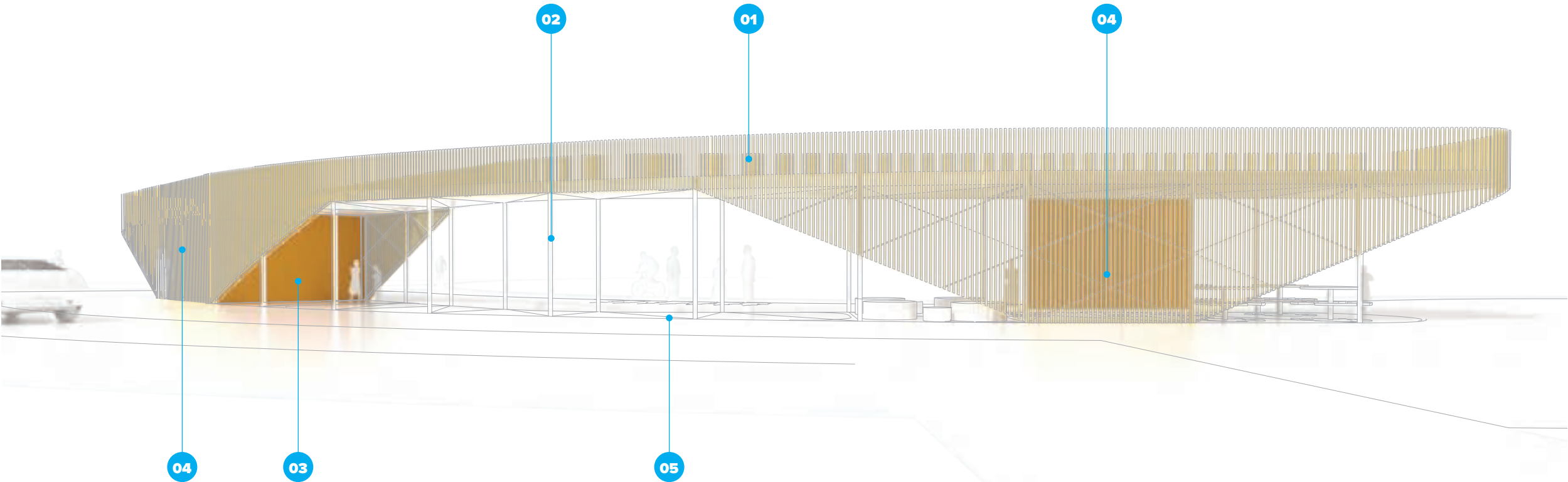

**01 Building Skin**  
 A lightweight translucent or perforated system defines space and diffuses natural light while opening up to landscape program.

**02 Building Structure**  
 Steel columns and beams are the primarily structural system with a lattice steel substructure providing support for the building skin

**03 Building Program**  
 Independent solid elements with integrated infrastructure support adjacent park activities

**04 Branding and Wayfinding**  
 Branding and wayfinding unique to each Urban Wilderness location is integrated into building program elements

**05 Plaza Surface**  
 Landscape program at the terminus extends through the open areas of the Gateway Pavilion